



Addendum No. 1

Date Issued: February 26, 2021

RFP Name: Carpet, Stair Treads, Cove Base and Rubber Tile Landings for District Buildings
RFP# 2021-PUR-004

The map of Santa Fe Trail Elementary has been updated on the LVT and carpet. The new map is attached as the second page. The LVT specifications are on the attached third page.

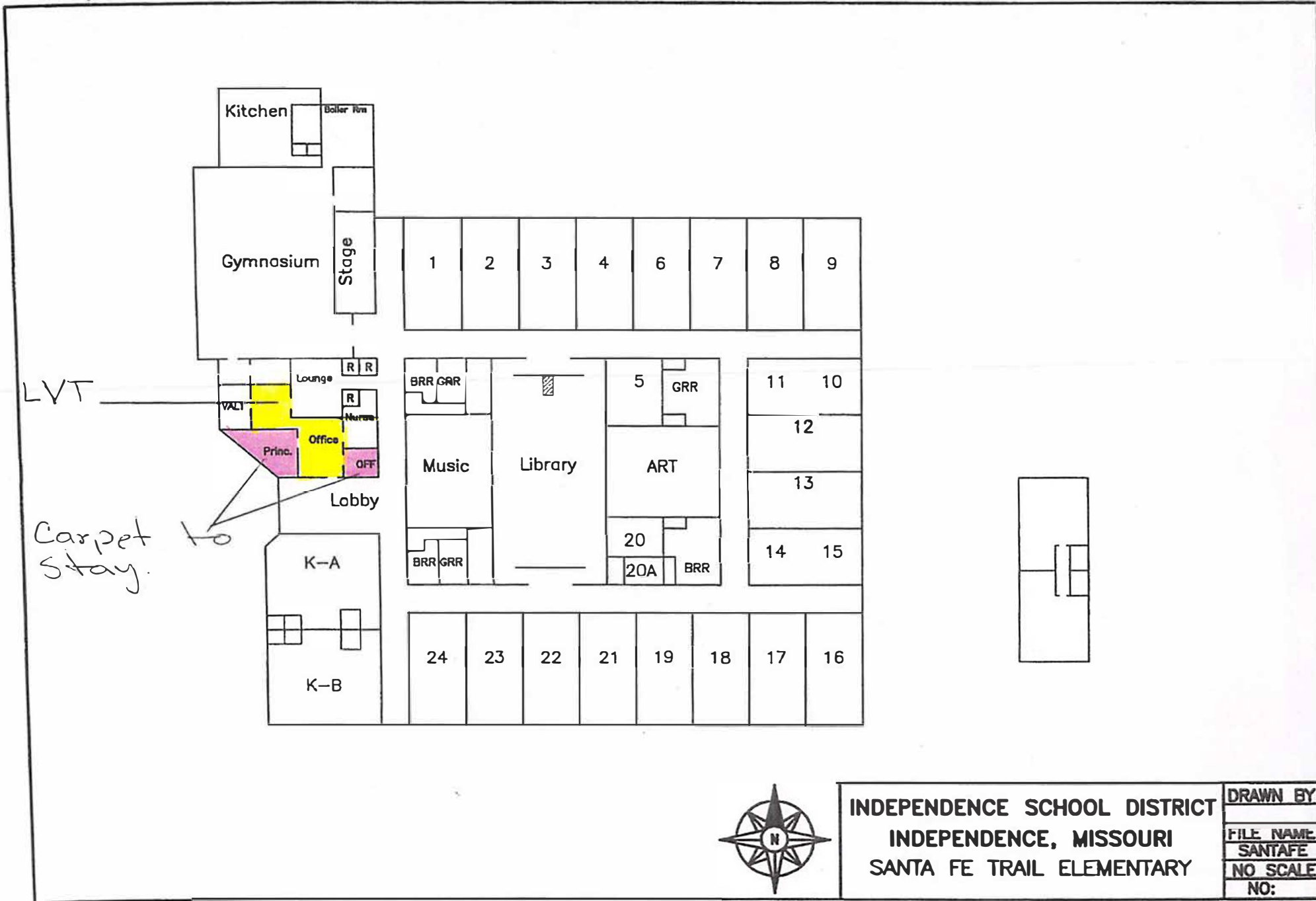

INDEPENDENCE SCHOOL DISTRICT INDEPENDENCE, MISSOURI SANTA FE TRAIL ELEMENTARY	DRAWN BY
	FILE NAME
	SANTAFE
	NO SCALE
	NO:



Installation Method



Ashlar

Herringbone

All product specifications reflect averages derived from product sample testing, are subject to normal manufacturing and testing tolerances and inherent pattern variances, and may be changed without notice. For more information about these and other important attributes of the product(s) described herein, including recycled content and product warranty information, [please see our full LVT product disclaimer.](#)

Product Textured Woodgrains **Color** A00404 Distressed Black Walnut

Product Specifications

Product Number	A004
Product Construction	High Performance Luxury Vinyl Tile
Class / ASTM F1700	Class III Printed Vinyl Plank
Wear Layer Thickness	22 mil
Total Thickness	4.5mm
Backing Class	Commercial Grade
Finish	Ceramor
Nominal Dimensions	25 cm x 1 m (9.845 in x 39.38 in)

Performance Specifications

IIC Sound Rating	(ASTM E492-09) 64 IIC
Slip Resistance	(ASTM D2047) >0.55 wet/dry, ADA Compliant
Static Load Limit	(ASTM F970) 1500 psi
Flexibility	(ASTM F137) Passes
Resistance to Heat	(ASTM F1514) Passes
Resistance to Light	(ASTM F1515) Passes
Radiant Flux	(ASTM E648) Class I
Smoke Density	(ASTM E 662) ≤ 450
Size & Squareness	(ASTM F2055) Passes, +/- 0.016 in. per linear foot
Thickness	(ASTM F386) Passes
Dimensional Stability	(ASTM F2199) Passes
Residual Indentation	(ASTM F1914) Passes
Resistance to Chemicals	(ASTM F925) Passes

Health + Environmental Specifications

Embodied Carbon (Cradle to Gate)	12.4 Kg CO ₂ /M ²
Full Life Cycle Carbon Emissions	Carbon Neutral Floors™
Total Recycled Content (Pre Consumer)	39%
Indoor Air Quality	GREENGUARD Gold FloorScore® CDPH 01350 compliant
Material Composition	Free of Ortho Phthalates, Added Formaldehyde and Heavy Metal Stabilizers
Disclosure of Environmental Impacts	Environmental Product Declaration
Disclosure of Product Ingredients	Health Product Declaration
Environmental Certifications	NSF/ANSI 332 Silver
LEED v4	Contributes to IEQ: Low Emitting Materials; M&R: EPD and EPR
End of Life	Fully Recyclable into Carpet Tile Backing through ReEntry®

Packaging

Quantity per Carton	26.91 sq. ft. (2.5 m ²)
Pieces per Carton	10
Weight per Carton	18 kg (40 lbs)
Cartons per Pallet	40
Pallets per Truckload	20

Technical Information

Installation	Interface LVT Installation Guidelines
Maintenance	Recommended Interface LVT Maintenance Guidelines
Reclamation	Recyclable through ReEntry® - Call 1.888.733.6873 (U.S.) / 1.866.398.3191 (Canada)
Warranty	15 Year Standard LVT Warranty